

PROPOSED LAY OUT PLAN OF RISHIKAPURAM

AT. - C.B. RAMAN WARD, NEAR TINEY TOT'S SCHOOL, PH. NO. - 56,

B. N. - 436, KH. NO. - 54/3,56/4,56/5,57/1,56/17,57/2

DISTT - SEONI BELONG TO RISHIKAPURAM

BY Er. RAJEEV MISHRA TILAK WARD, SEONI (M.P.)

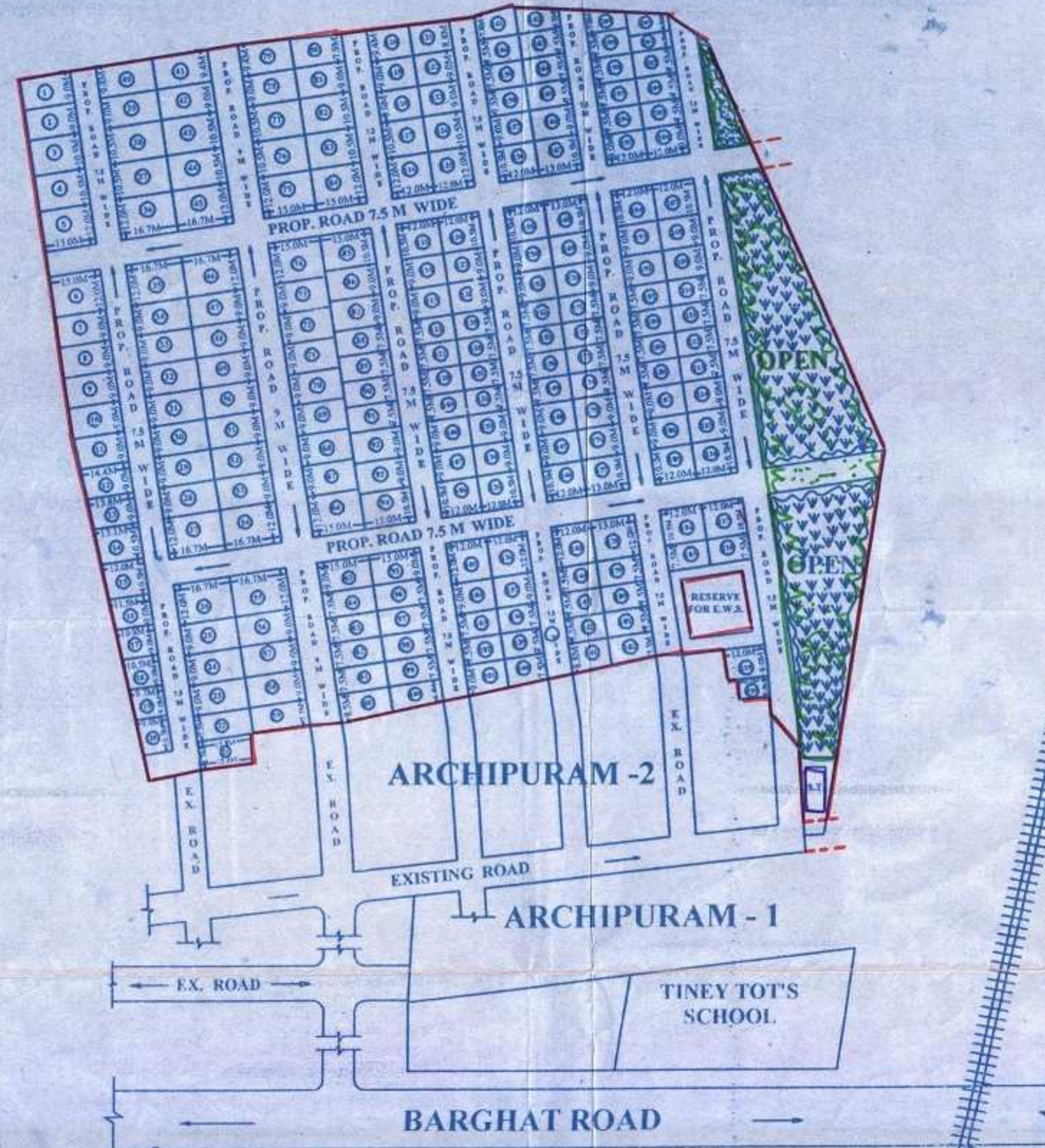

अनुमोदित

सयुक्त संभालक 16/6/2011

नगर तथा ग्राम निवेश कार्यालय छिन्दवाड़ा

रद्विती की 3 वर्ष अवधि दि. 16/6/11

LOCATION PLAN

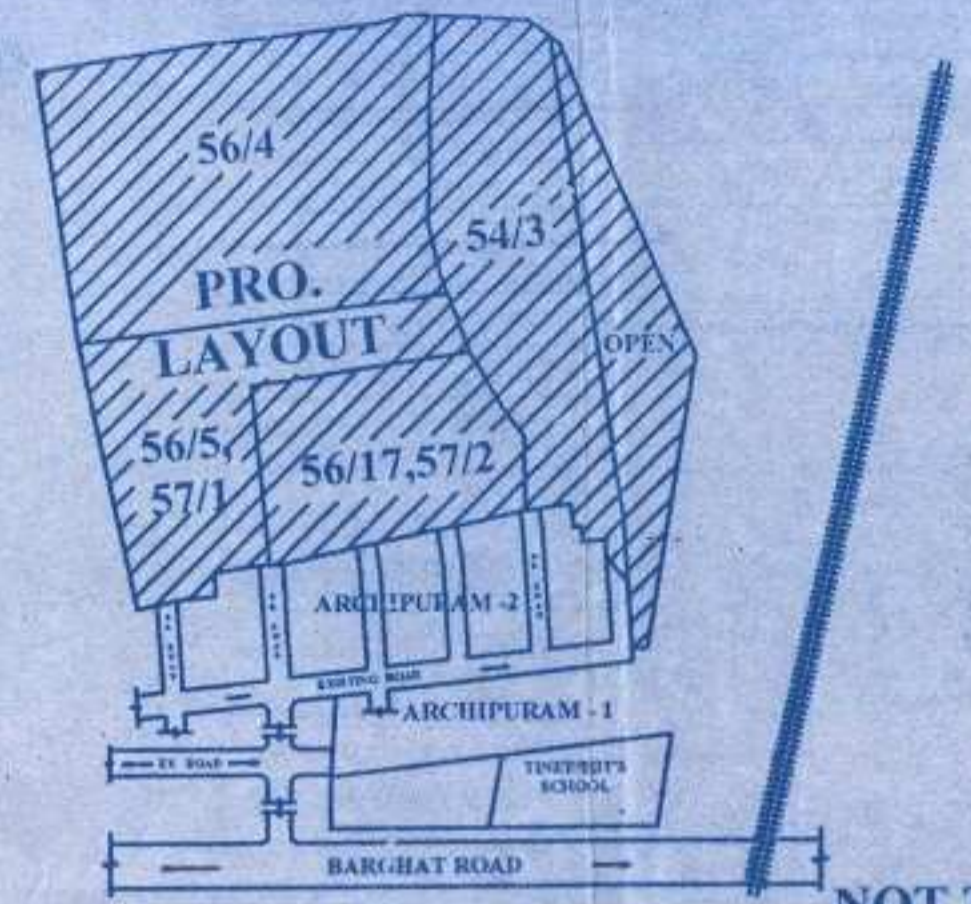

NOT TO THE SCALE

AREA STATEMENT

TOTAL LAND AREA	- 43180.00 SQM	(100.00%)
PLOTS AREA	- 26796.00 SQM	(62.22%)
ROADS AREA	- 11280.02 SQM	(26.13%)
OPEN AREA	- 4404.17 SQM	(10.19%)
LAND FOR E.W.S. AREA	- 699.81 SQM	(1.46%)
PLOT SIZE 24.40 M x 25.73 M.		
(CONST. AREA OF E.W.S. G+2 = 335.80 SQM)		
Each Unit 22.38 Sq.mt. Nos of Unit 45		

L.I.G. PLOT'S 7.5 m x 12.00 m. Plot No. - 102,103,109,110,111,112,129,130, 131,132,138,139,149,150,151,152,158,159,160,161,183,188,189,190, 191,197,198,199,200,210,211,212,213,218,220 Total Nos of Plot's - 35 No.

SCALE - 1:1000	
OWNER	ENGINEER
<p>ENGINEER RAJEEV MISHRA Contractor, Valuer & Planner Mishra Consultant & Engineer's Barghat Road, Near M.P.E.B. Office</p> <p>Er. RAJEEV MISHRA Mob. No. - 9425175371</p> <p>Reg. No. 05/T.&C. PLANNING No. 176/M.C. MISHRA CONSULTANT & ENGINEER'S OFFICE - BARGHAT ROAD, NEAR M.P.E.B. OFFICE DIST. - SEONI (M.P.) Mob. - 9425175371, 9425427189</p>	
<p>COLONIZER Er. RAJEEV MISHRA LIC. NO. - 05/2008 RES. ADD. - TILAK WARD, SEONI DISTT. - SEONI (M.P.) Mob. - 9425175371, 9425427189</p>	